

# Rumble Tuff® Baby Medicine Dispenser with Measuring Syringe

BD200



Rumble Tuff®

## The easy way to give your baby medicine or dietary supplements.

The Baby Medicine Dispenser combines the benefits of a pacifier and a medicine feeder. The specially designed, no-spill ventilation hole prevents leakage and allows you to stop the flow or add additional liquid at any time. The translucent color allows you to observe dispensing. It is adaptable to most standard measuring syringes (one provided) for additional medicine or your baby's favorite liquid.

### How to Use:

#### A - Direct Medicine Dosing Through Pacifier

1. Before first use, wash all parts with warm water and a mild liquid soap to sterilize. Rinse thoroughly with clean hot water.
2. Before each use, check nipple for visible wear or damage.
3. With the nipple pointing up, use thumb and finger to pry open the cup.
4. Pour in the precise dosage (max 5ml) of medication (See Diagram A).
5. Close the dispenser by snapping shut. Check the edges for a secure seal.
6. Place nipple into baby's mouth. You may stop dispensing at anytime by blocking the ventilation hole with your finger.
7. Remove Baby Medicine Dispenser and clean.

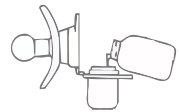

Diagram A

#### B - Medicine Added by Measuring Syringe Method

1. Pour baby's favorite liquid into the dispenser cup.
2. Close the dispenser by snapping shut. Check the edges for a secure seal.
3. Use the Measuring Syringe (included underneath the inner tray) to measure the precise dosage of medicine or dietary supplement.
4. Place Measuring Syringe tip in the ventilation hole of dispenser cup (See Diagram B).
5. Place the nipple in your baby's mouth. Slowly push plunger to add medicine to your baby's favorite liquid in the dispenser cup. (The plunger of the Measuring Syringe may move forward without force when baby is ingesting contents of Baby Medicine Dispenser.)
6. Remove the Measuring Syringe immediately after dispensing to keep the ventilation hole open.
7. Remove Baby Medicine Dispenser after contents has been swallowed.
8. Clean the Baby Medicine Dispenser and Measuring Syringe.

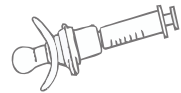

Diagram B

### Warning/Caution:

- Always rinse with warm water before and after each use. Dry each part completely before reassembling and/or storing in provided storage container.
- Do not expose to extreme heat or cold. Do not expose to direct sunlight. Store your Baby Medicine Dispenser and/or Measuring Syringe in a cool, dry place away from children. Use only with adult's supervision, never leave the baby unattended while using the unit. This product is not a toy, do not allow children to play with it.
- To prevent possible choking, check nipple for cracks and/or tears before each use.
- The pink body of medicine feeder is not dishwasher safe, do not put it into dishwasher.
- Measurement marking on the Rumble Tuff® Baby Medicine Feeder is for reference only. For accurate dosage measurement, please use the attached Measuring Syringe or other measuring device provided by your doctor.
- Dispose of Baby Medicine Dispenser or Measuring Syringe after any visible wear or damage.

### Specifications:

The Baby Medicine Dispenser holds 5ml (approximately 1 tsp) of liquid.

Cherry shaped silicone nipple.

BPA Free.

Patents:

US #6,110,193

# Rumble Tuff® Baby Nasal Aspirator

## BN303

---

### Instant relief for baby's stuffy nose.

The Rumble Tuff® Baby Nasal Aspirator is the best way to provide your baby with instant, gentle relief for their runny or stuffy nose. Users can effortlessly monitor and control the suction level. The clear silicone tip is easily removable for cleaning and is hygienically safe.

### How to Use:

1. Tuck nozzle tightly into baby's nostril to create a seal.
2. Put suction end into care-givers mouth. Let lips rest against the flower-petal stopper.
3. Start sucking through the mouth piece. Maintain or increase suction strength until baby's mucus is trapped inside the collection chamber.
4. Gently remove nozzle from baby's nostril.

### How to Clean:

1. Pull up on the nasal tip to remove collection cup from the aspirator. Pull tubing away from the other end of the aspirator.
2. Gently squeeze collection cup sides together to open the bottom of the cup.
3. Over a sink, wash collection cup with warm water. Rinse tubing, starting with the mouthpiece and letting the warm water flow through tubing and out into the sink.
4. Allow all parts to completely dry before reassembling and/or placing in the storage container.

### Tips:

1. Put an over-the-counter saline drop in baby's nostril to moisten baby's sensitive, dry, or stuffy nose. (You can make your own simple saline solution by adding 1/4 teaspoon of salt into 1 cup of clean water.)
2. The manual Baby Nasal Aspirator is more effective when baby is crying or when their mouth is open.

### Warning/Caution:

- Wash all parts with warm water before and after each use. Pat dry with a cloth or paper towel. Let each part dry completely before reassembling and/or storing in the provided storage container.
- The blue main body of aspirator is not dishwasher safe, do not put it into dishwasher.
- Do not expose to extreme heat or cold. Do not expose to direct sunlight. Store your manual Baby Nasal Aspirator in a cool, dry place away from children. Use only with adult's supervision, never leave the baby unattended while using the unit. This product is not a toy, do not allow children to play with it.
- Fluid or moisture from the care-givers mouth may appear in the tubing. Please follow the cleaning instructions above.
- Dispose of Baby Nasal Aspirator after any visible wear or damage.

### Specifications:

BPA free.  
Silicone nozzle.

Made In China  
75-ST10700-RB01

Rumble Tuff® trademark owned by  
**A Cute Baby, Inc.**  
865 N 1430 W Orem, UT 84057  
Ph: 1-801-609-8168 Fax: 1-801-796-2688  
e-mail: customerservice@acutebaby.com  
www.rumbletuff.com www.acutebaby.com